

PS40k2 C-SJ120-3

Solar Submersible Pump System for 8" wells

System Overview

| | |
|-----------|----------------------------|
| Head | max. 55 m |
| Flow rate | max. 241 m ³ /h |

PS DataModule – Integrated Data Logger and advanced pump management features. Allows for simple system configuration, real-time and stored data plus provides Bluetooth communication to PumpScanner Android™ App and PS Communicator.*

Technical Data

Controller PS40k2

- Control inputs for dry running protection, remote control etc.
- Protected against overload and overtemperature
- Integrated MPPT (Maximum Power Point Tracking)

| | |
|-----------------|-------------|
| Power | max. 37 kW |
| Input voltage | max. 850 V |
| Optimum Vmp** | > 575 V |
| Motor current | max. 65 A |
| Efficiency | max. 98 % |
| Ambient temp. | -30...50 °C |
| Enclosure class | IP54 |

Motor AC DRIVE SUB 6" 30kW

- Highly efficient 3-phase AC motor
- Frequency: 25...53 Hz
- Premium materials, stainless steel: AISI 304
- No electronics in the motor

| | |
|------------------|-------------------|
| Motor speed | 1,400...3,020 rpm |
| Power factor | 0.88 |
| Insulation class | F |
| Enclosure class | IP68 |
| Submersion | max. 300 m |

Pump End PE C-SJ120-3

- Non-return valve
- Premium materials, stainless steel: AISI 304
- Optional: dry running protection
- Centrifugal pump

Pump Unit PU40k2 C-SJ120-3 (Motor, Pump End)

| | |
|-------------------|-------------|
| Borehole diameter | min. 9,8 in |
| Water temperature | max. 30 °C |



Standards

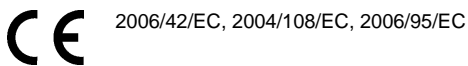

IEC/EN 61702:1995, IEC/EN 62253 Ed.1

The logos shown reflect the approvals that have been granted for this product family. Products are ordered and supplied with the approvals specific to the market requirements.

* PS DataModule is included in all PSk2 controllers and any PS controllers with –D in their description. –D variants should be ordered if there is a potential need to use the PS DataModule features in the future as this is not a retrofit option.

**Vmp: MPP-voltage under Standard Test Conditions (STC): 1000 W/m² solar irradiance, 25 °C cell temperature



PS40k2 C-SJ120-3

Solar Submersible Pump System for 8" wells

Pump Chart

V_{mp}* > 575 V

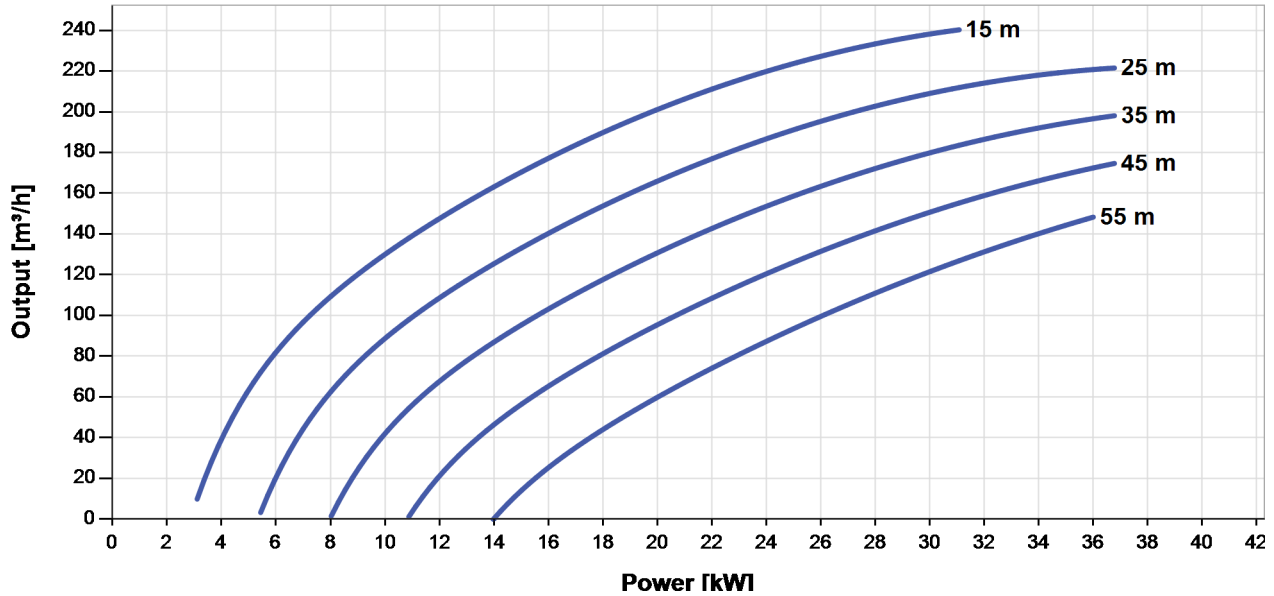

Dimensions and Weights

Controller

H = 500 mm
 H1 = 450 mm
 H2 = 425 mm
 W1 = 320 mm
 W2 = 290 mm
 D = 9.0 mm
 D1 = 220 mm
 D2 = 250 mm

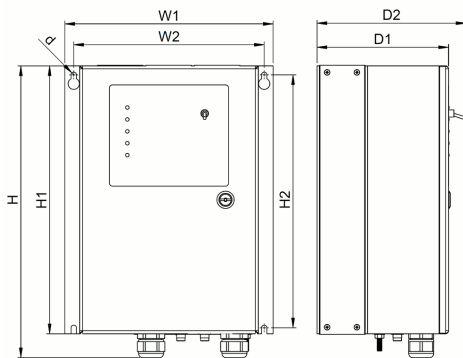

Pump Unit

A = 1,971 mm
 B = 1,120 mm
 C = 851 mm
 D = 143 mm
 E = 230 mm
 S = 6 in

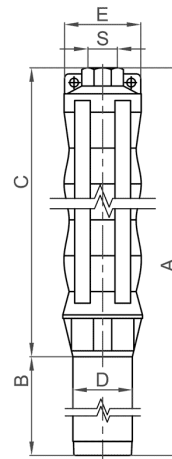

| | Net weight |
|------------|------------|
| Controller | 17 kg |
| Pump Unit | 132 kg |
| Motor | 90 kg |
| Pump End | 42 kg |

*V_{mp}: MPP-voltage under Standard Test Conditions (STC): 1000 W/m² solar irradiance, 25 °C cell temperature

